

NOTES:

1. REFER TO NU-VUE WEBSITE FOR MOST CURRENT INFORMATION.
2. REFER TO TECHNICAL INFORMATION SHEETS FOR FASCIA SIZES, ACCESSORIES, AND FINISHES AVAILABLE.
3. WOOD NAILER MUST BE INSTALLED TO MEET APPLICABLE BUILDING CODES OR 200 LBS PER LINEAR FOOT MINIMUM IN ANY GIVEN DIRECTION.
4. REFER TO THE NU-VUE TECHNICAL DATABASE FOR FASTENER/METAL COMPATIBILITY.
5. APPLICATION DETAILS ARE FOR ILLUSTRATION PURPOSES ONLY AND MAY NOT BE APPROPRIATE FOR ALL BUILDING DESIGNS AND CONDITIONS.

RAKE WITH MODIFIED J-CHANNEL

ACCEPTABLE SYSTEMS: NV 1.5" & NV 2" STANDING SEAM

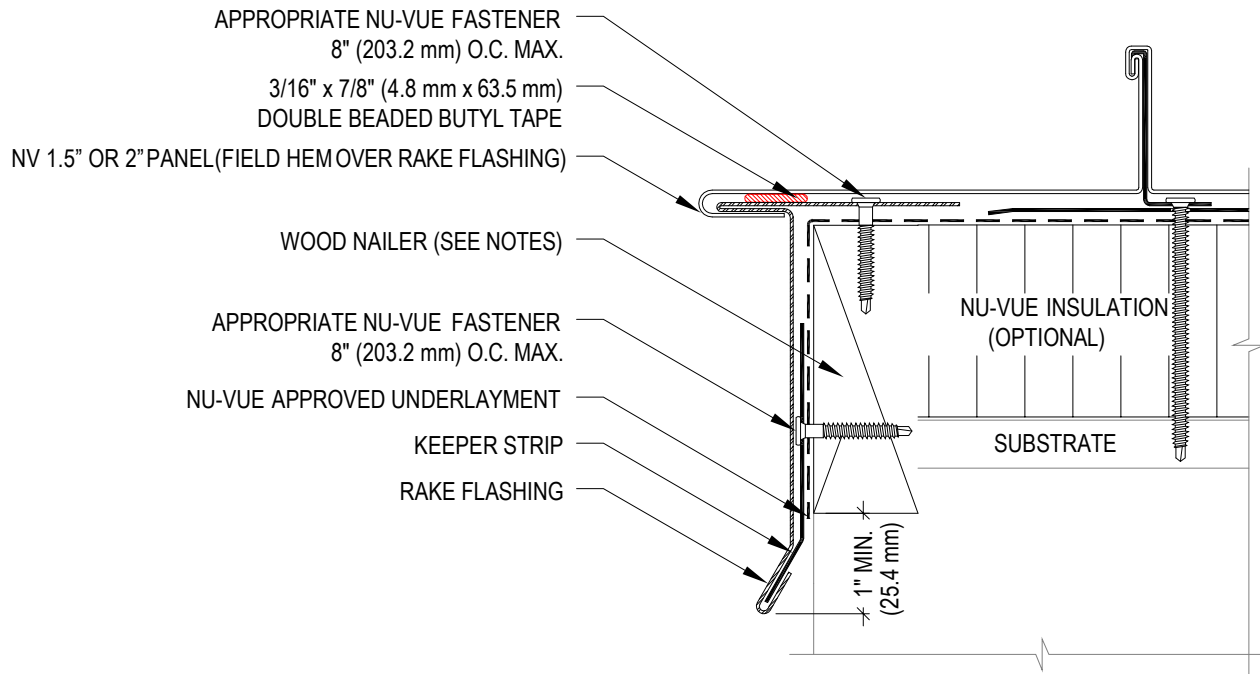

NOTES:

1. REFER TO NU-VUE WEBSITE FOR MOST CURRENT INFORMATION.
2. REFER TO TECHNICAL INFORMATION SHEETS FOR FASCIA SIZES, ACCESSORIES, AND FINISHES AVAILABLE.
3. WOOD NAILER MUST BE INSTALLED TO MEET APPLICABLE BUILDING CODES OR 200 LBS PER LINEAR FOOT MINIMUM IN ANY GIVEN DIRECTION.
4. REFER TO THE NU-VUE TECHNICAL DATABASE FOR FASTENER/METAL COMPATIBILITY.
5. APPLICATION DETAILS ARE FOR ILLUSTRATION PURPOSES ONLY AND MAY NOT BE APPROPRIATE FOR ALL BUILDING DESIGNS AND CONDITIONS.

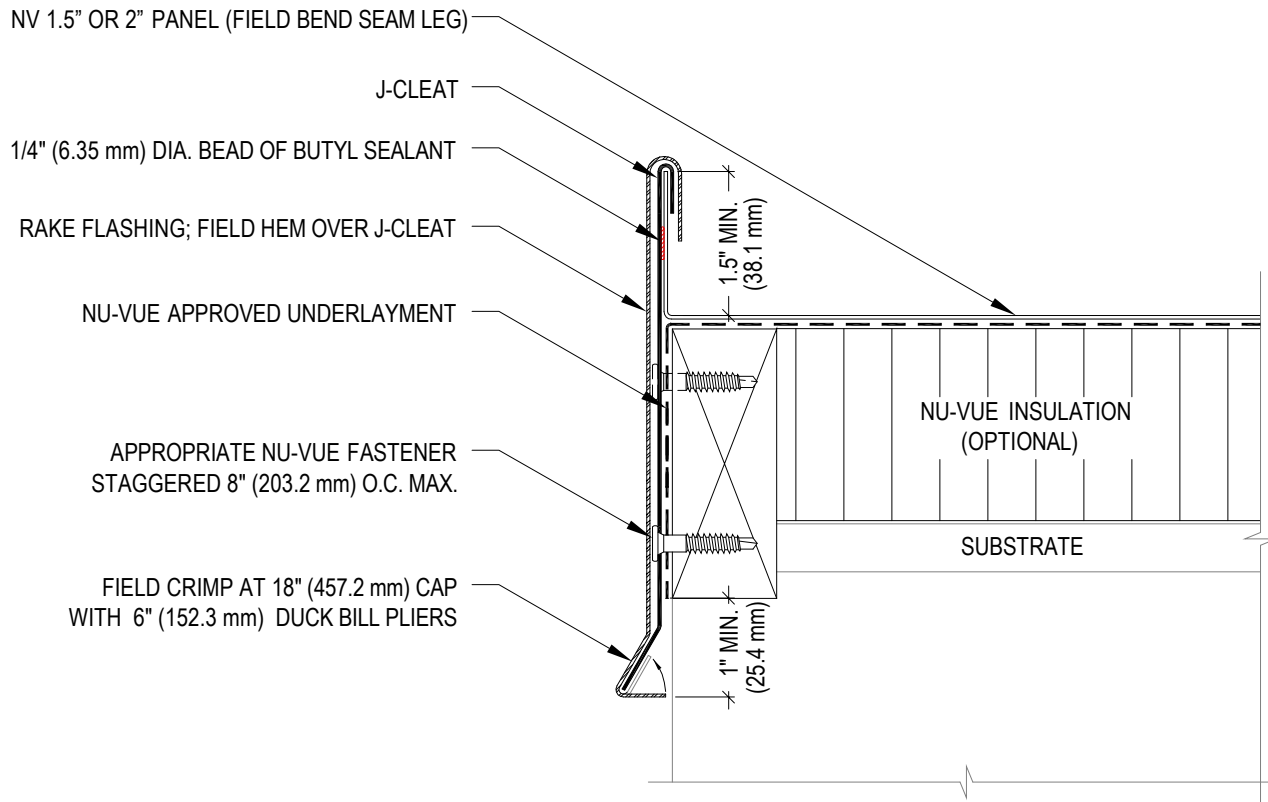

NOTES:

1. REFER TO NU-VUE WEBSITE FOR MOST CURRENT INFORMATION.
2. REFER TO TECHNICAL INFORMATION SHEETS FOR FASCIA SIZES, ACCESSORIES, AND FINISHES AVAILABLE.
3. WOOD NAILER MUST BE INSTALLED TO MEET APPLICABLE BUILDING CODES OR 200 LBS PER LINEAR FOOT MINIMUM IN ANY GIVEN DIRECTION.
4. REFER TO THE NU-VUE TECHNICAL DATABASE FOR FASTENER COMPATIBILITY WITH METAL.
5. REFER TO THE NU-VUE TECHNICAL DATABASE FOR HEM LENGTH AND REQUIRED DISTANCE BETWEEN THE PANEL AND CLEAT.
6. APPLICATION DETAILS ARE FOR ILLUSTRATION PURPOSES ONLY AND MAY NOT BE APPROPRIATE FOR ALL BUILDING DESIGNS AND CONDITIONS.