

UN DER NO CIRC UMST ANCES  
CAN THE PIPE PENETRA TE  
OR COME WITHIN 4"  
(10 1.6 mm) OF THE  
PANEL SEAM.

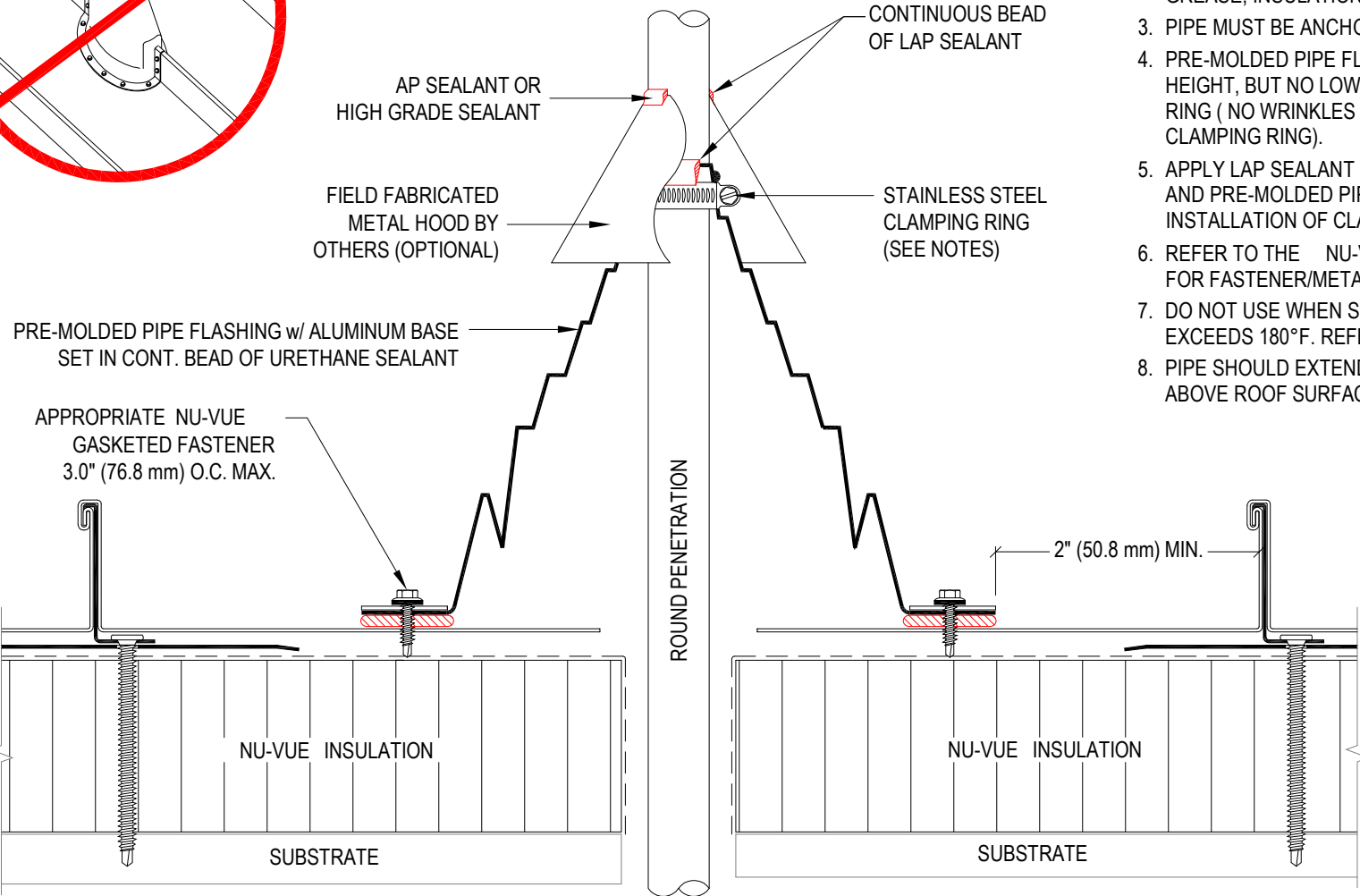

**NOTES:**

1. REFER TO NU-VUE WEBSITE FOR MOST CURRENT INFORMATION.
2. REMOVE ALL EXISTING FLASHINGS, LEADS, ETC. PIPE SURFACE MUST BE FREE OF ALL RUST, GREASE, INSULATION, ETC.
3. PIPE MUST BE ANCHORED TO ENSURE STABILITY.
4. PRE-MOLDED PIPE FLASHING MAY BE CUT TO HEIGHT, BUT NO LOWER THAN REINFORCING RING ( NO WRINKLES OR FOLDS UNDER CLAMPING RING).
5. APPLY LAP SEALANT BETWEEN PENETRATION AND PRE-MOLDED PIPE FLASHING PRIOR TO INSTALLATION OF CLAMPING RING.
6. REFER TO THE NU-VUE TECHNICAL DATABASE FOR FASTENER/METAL COMPATIBILITY.
7. DO NOT USE WHEN SERVICE LINE TEMP. EXCEEDS 180°F. REFER TO 3-P-4.
8. PIPE SHOULD EXTEND A MINIMUM OF 8" (203.2 mm) ABOVE ROOF SURFACE.

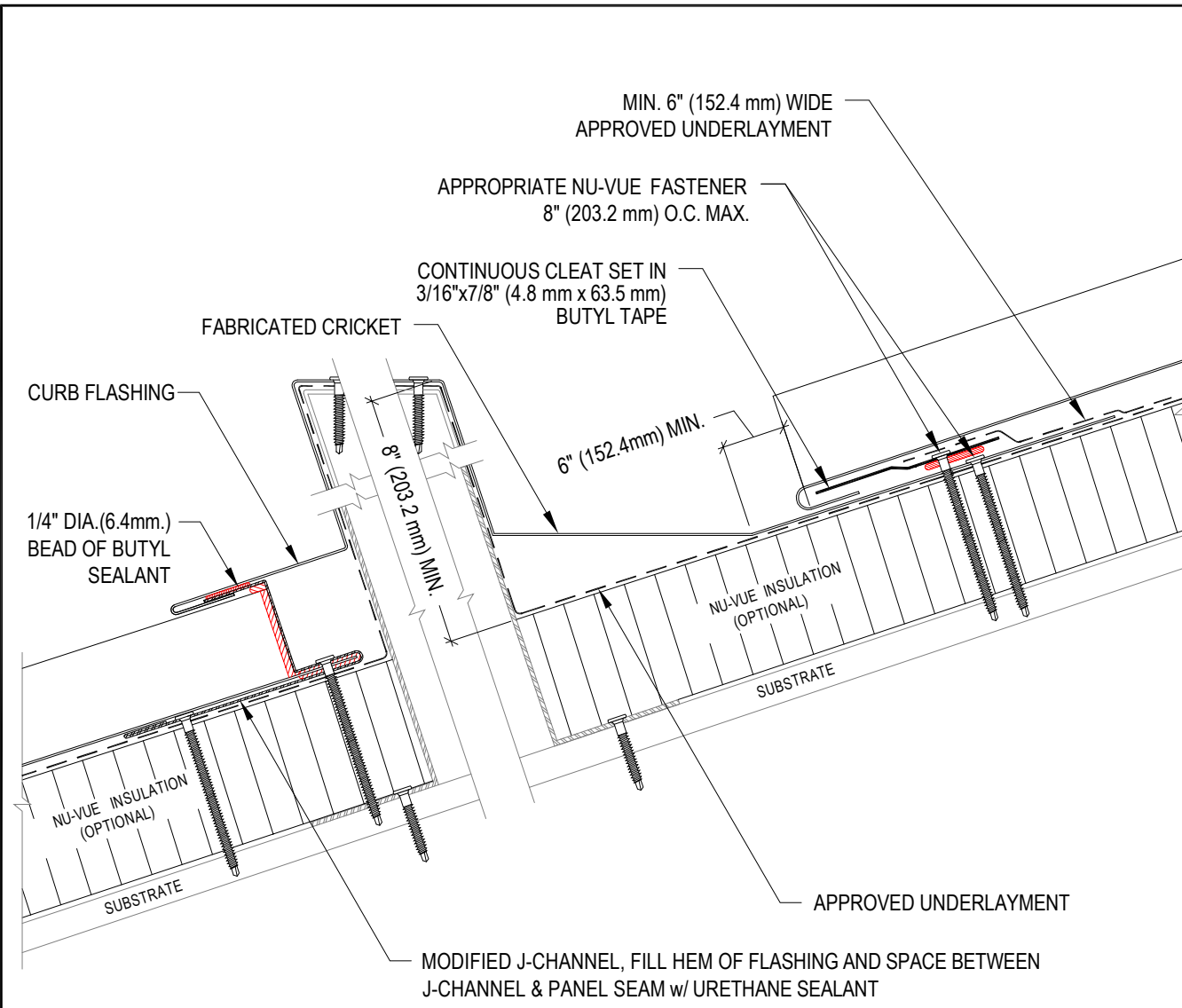

NOTES:

1. REFER TO NU-VUE WEBSITE FOR MOST CURRENT INFORMATION.
2. REFER TO TECHNICAL INFORMATION SHEETS FOR FASCIA SIZES, ACCESSORIES, AND FINISHES AVAILABLE.
3. REFER TO THE NU-VUE TECHNICAL DATABASE FOR FASTENER/METAL COMPATIBILITY.
4. APPLICATION DETAILS ARE FOR ILLUSTRATION PURPOSES ONLY AND MAY NOT BE APPROPRIATE FOR ALL BUILDING DESIGNS AND CONDITIONS.
5. REFER TO THE NU-VUE TECHNICAL DATABASE FOR HEM LENGTH AND REQUIRED DISTANCE BETWEEN THE PANEL & CLEAT.

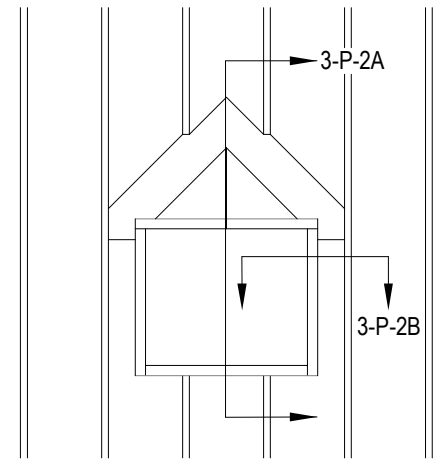

www.nuvuepr.com

CURB - HIGH & LOW SIDE DETAIL

ACCEPTABLE SYSTEMS: NV 1.5" & NV 2" STANDING SEAM

NOTES:

1. REFER TO NU-VUE WEBSITE FOR MOST CURRENT INFORMATION.
2. REFER TO TECHNICAL INFORMATION SHEETS FOR FASCIA SIZES, ACCESSORIES, AND FINISHES AVAILABLE.
3. REFER TO THE NU-VUE TECHNICAL DATABASE FOR FASTENER/METAL COMPATIBILITY.
4. APPLICATION DETAILS ARE FOR ILLUSTRATION PURPOSES ONLY AND MAY NOT BE APPROPRIATE FOR ALL BUILDING DESIGNS AND CONDITIONS.

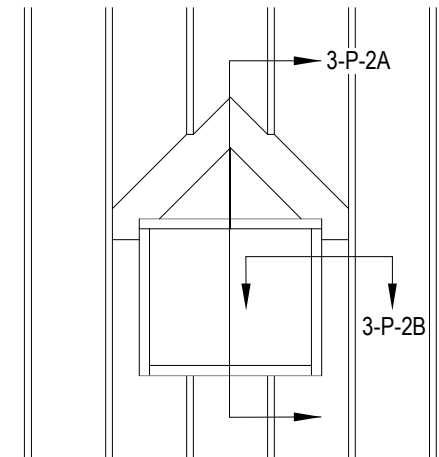
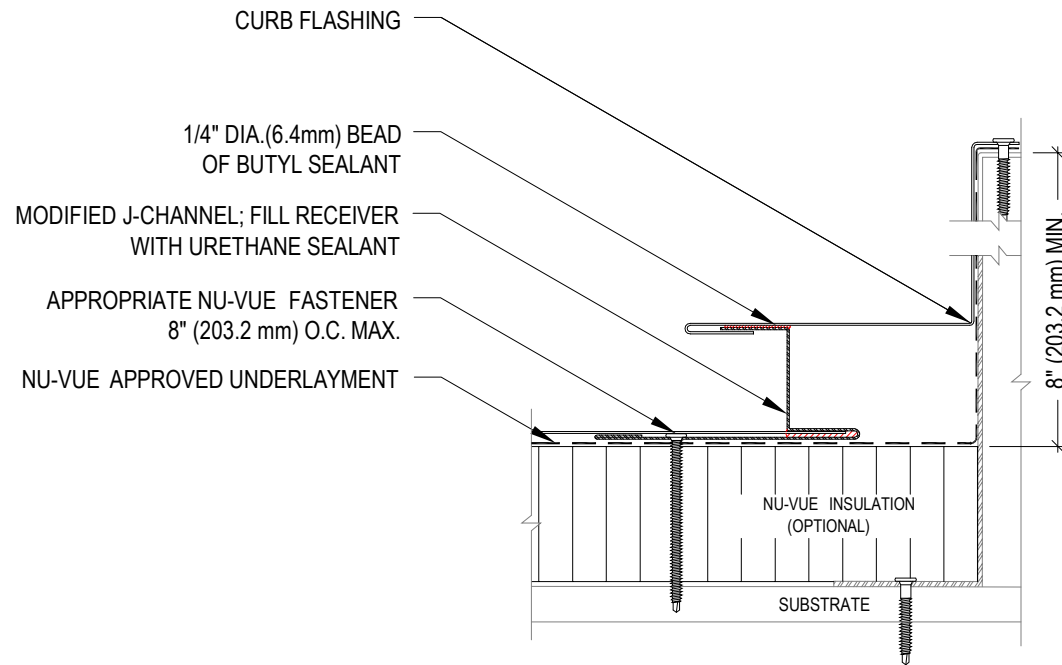

www.nuvuepr.com

CURB - RAKE DETAIL

ACCEPTABLE SYSTEMS: NV 1.5" & NV 2" STANDING SEAM